

VOGLER[®]

TOOLS, WORK, INTEGRITY

V10377

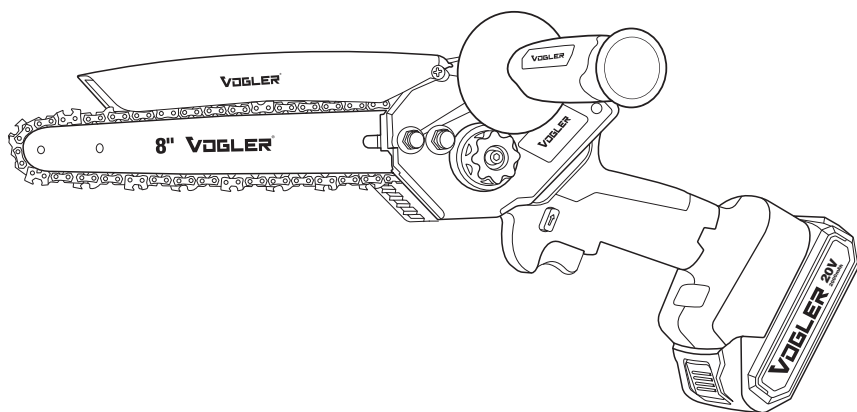

BRUSHLESS CHAINSAW 8" 20V



TECHNICAL SPECIFICATION

| | |
|---------------------------------------------------------|-------------------------------------------------------------------------------|
| Model | V10377 |
| Voltage | 20V |
| Battery Type | Lithium battery |
| Battery Capacity | 2Ah |
| Maximum Cutting Diameter | 140mm |
| Chain Size | 290mm |
| Chain Bar Length | 239mm |
| No-Load Speed | 3800RPM |
| Chain Speed | 5m/s |
| Oil Tank Capacity | 25ml |
| Cuts Per Battery Charge (Cutting Diameter 110mm) | 30 Pcs |
| Charging Time | 1h |
| Net Weight | 1.47Kg |
| Total Weight | 2.25Kg |
| Include | 2 pcs Battery 1 pc Charger 1 pc Handle 1 pc Wrench 1 pc Bar Cover |

PARTS LIST

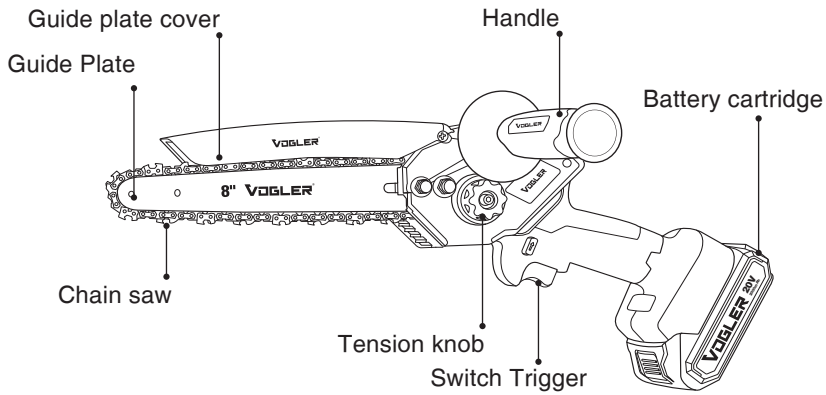

FUNCTION DESCRIPTION

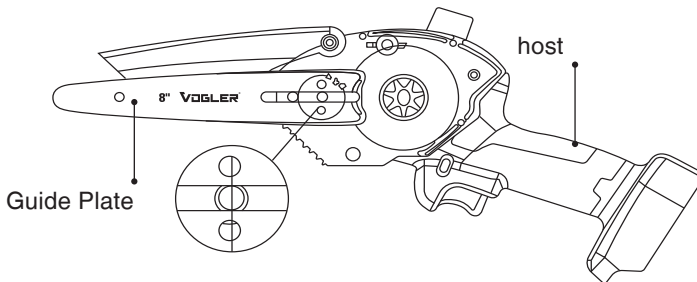

Loosen the nut counterclockwise and remove the side cover.

OPERATING INSTRUCTION

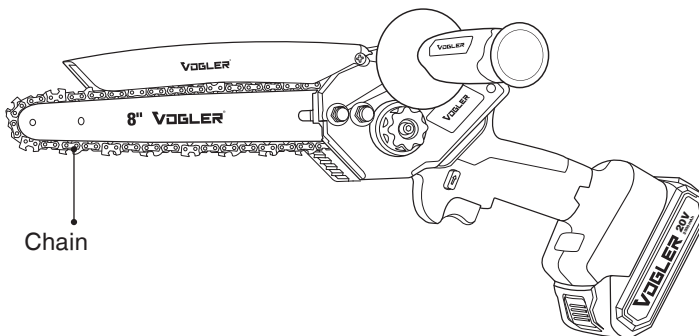

- How to remove the chain:
- loosen the compression button, and remove the side cover
- After removing the side cover as shown in the picture, remove the guide directly.
- How to install the chain guide plate:
- Load the chain onto the guide plate so that the middle guide tooth fits securely into the guide plate guide slot.

NOTE: The chain blade should be facing forward.

NOTE: The charging chainsaw has a device to adjust the tension of the chain.

When installing the guide plate, make sure that the adjusting block gets stuck into the positioning adjusting hole at the end of the guide plate!

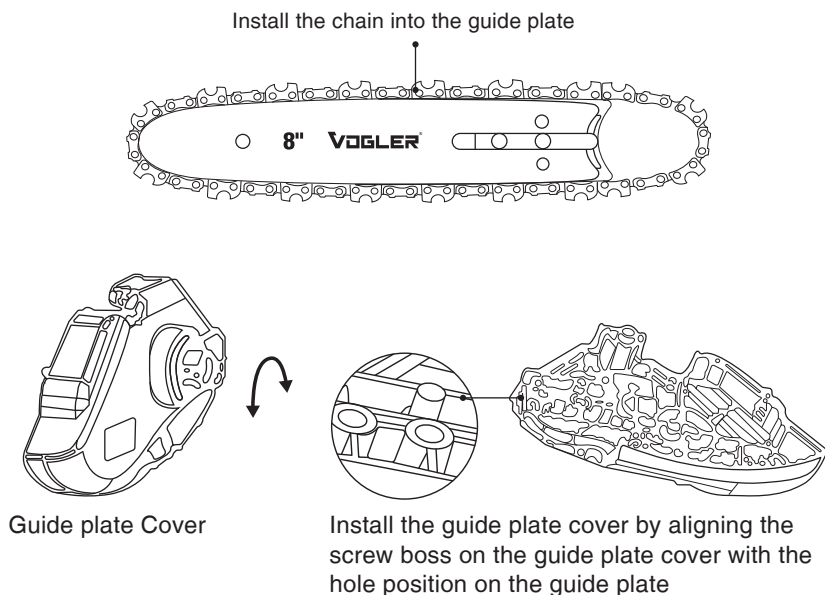

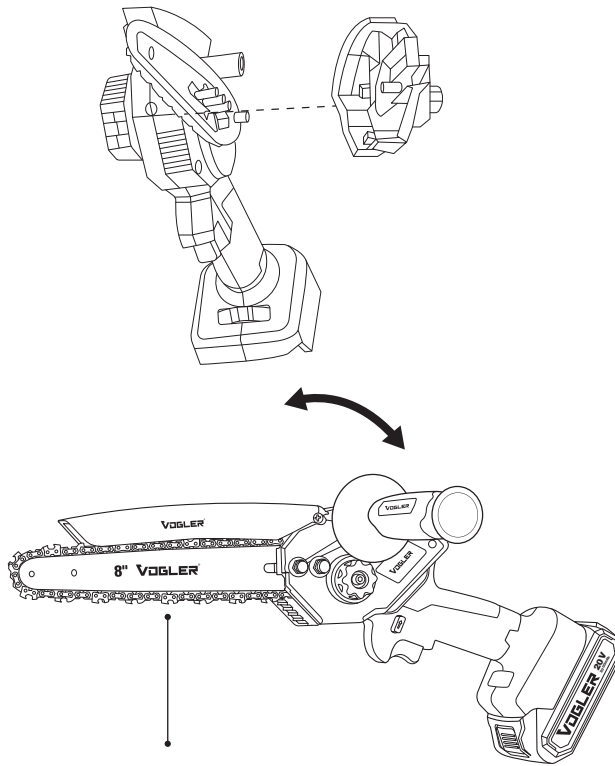

Manually Screw the M6 Nut into the Machine

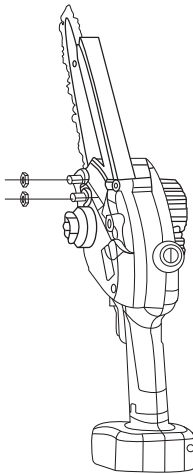

M6 outer hexagonal flange nut

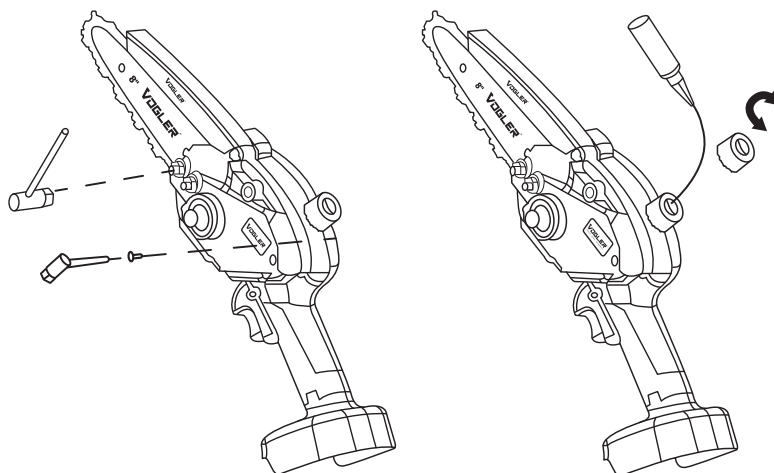

Open the oil cover, pour the lubricating oil into the oil bottle, and tighten the oil cover

- The chain tightness is shown below.

NOTE: 1-3 Middle guide teeth are exposed in the pull-down chain.

- The new chain will stretch during the early stages of use. Please check and adjust to the appropriate tension frequently, as a loose chain is prone to derailing, which can cause rapid wear of the chain and guide plate.

The chain must be stuck to the sprocket. After installation, please check it again.

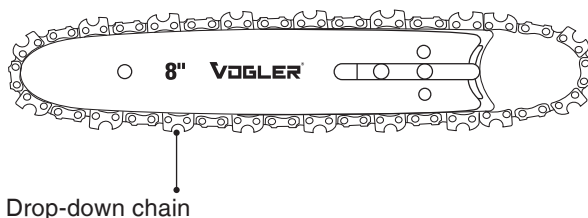

Pull down the chain to expose the three middle guide teeth.

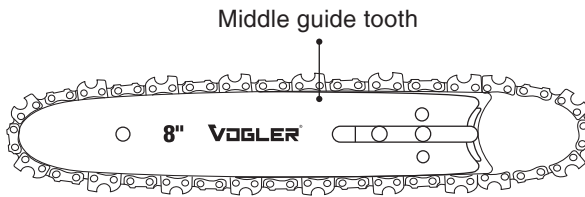

Pulling down the chain, leaving 1-3 middle guide tooth

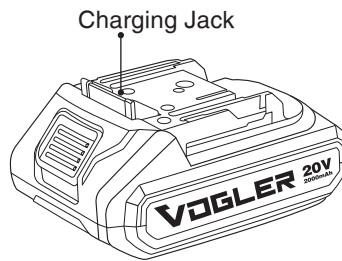

BATTERY PACKING: Ensure slots and inserts are properly aligned.

Install the battery into the machine

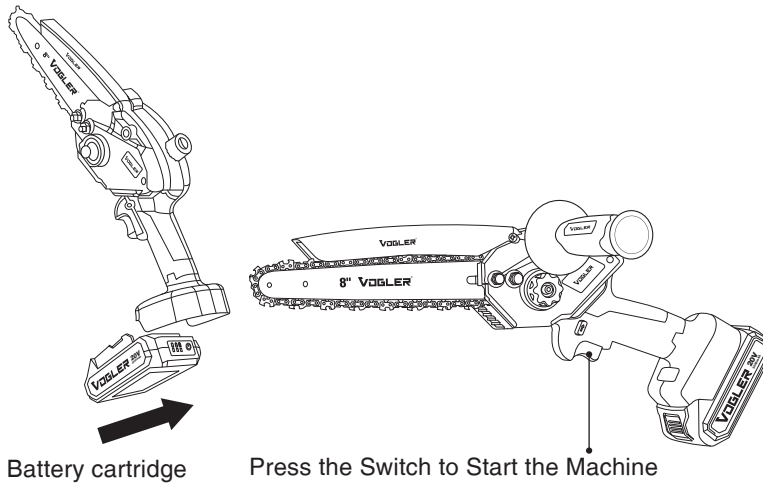

CHARGING THE BATTERY

- Do not expose the battery to extreme conditions such as high temperature or shock. Otherwise, it will cause personal injury due to the leakage of the electrolytic solution.

- Before charging, make sure the surface of the battery is clean and dry. Note that before delivery, the battery of this product is not fully charged.

Therefore, before the first use, there must be sufficient electricity.

- Do not charge the battery for long periods, and do not run out of all the power in the soap tank, otherwise, it will damage the battery.

- If the battery life is significantly shorter despite being fully charged, it must be replaced, as the battery is exhausted.

- The user can only use the battery pack manufactured by the original equipment and serviced by the customer center.

- Always keep in mind applicable safety instructions, protection requirements, and environmental information.

- Put the charger in a room that temperature is between 10°C and 40°C, and prevent moisture from entering.

- Make sure the switch is in the off position.

- Connect the charger to the corresponding connector for the battery pack.

- Ensure the power supply is consistent with the rated values on the charger and adapter.

- The red light on the charger indicates that the battery is charging. The green light indicates that charging is complete. The average charging time is 2 hours.

- Ensure the battery is recharged at least once every three months.

CONDITION OF USE

Maintain charging temperature between 0°C-45°C and discharge temperature between -20°C to 60°C.

OPERATION

- Please wear suitable clothing and safety gloves when using the device. the start/off switch and the safety switch must be functional for normal use. When releasing the start switch, the power must be turned off.
- If the switch is damaged, don't use the device until replace it.
- The risk of injury can be minimized by wearing protective gear and ensuring all devices work properly.
- Verify the frequency of operation to ensure optimal performance.

SKILL

- When the device is running, keep your other hand at least 15cm away from the cutting area of the blade, ensuring it does not come into contact with the knife edge.
- Do not use this equipment to force larger branches, as it may cause the blade to deform or the pruning tool to stick.
- In cold or humid weather, to protect the battery pack, store it under waterproof coverings. Avoid using the equipment on rainy days.
- After daily use, we recommend disconnecting the pruning tool from the battery pack and ensuring the power switch is turned off. Store bot items together in the designated toolbox.

CLEANING AND MAINTENANCE

- Repairs to functions not mentioned herein should be performed by the service center.
- To ensure the safety of use, only use original parts.
- Safely disconnect the battery connection and store it in a secure package.
- Wear protective gloves when handling safety blades to prevent the sharp blades from scratching the user.
- Follow-up cleaning and maintenance must be carried out regularly. This ensures long-term and reliable operation of the

equipment.

CLEARANCE

- Do not spray water on the equipment or immerse it in water, as it may cause electric shock.
- Keep the ventilator, motor housing, and equipment handle clean. Use a damp cloth or brush to clean them. Do not use a harsh cleaner, as it may cause permanent equipment failure.
- Please clean the blade carefully after each use.
- Use an oily cloth to wipe the blade and apply a thin layer of oil to protect it from corrosion.
- After 8 hours of continuous operation, please remove debris such as dust from the front turbine cover plate of the equipment.

STORAGE

- Avoid to put fully charge battery pack in extremely hot or cold environments.
- If the equipment will not be used for a long time, please remove the battery before storing it.
- The batteries and the charger must be stored in the instrument box to prevent heat, dust, and moisture from entering.
- Check if the switch is off
- The battery should be stored in a dry environment with a temperature range of -20°C ~ 60°C.
- For short-term storage of less than one to six months, maintain a temperature between -10°C and 35°C.
- Keep a distance of at least 1.5 meters between the battery and any combustible materials.
- To ensure the service life of the equipment and prevent degradation, store it in a fully charged state.
- When not in use, charge and discharge the battery at least once a month.

INDICATOR LIGHT

RED: Charging

GREEN: Charging completed

TEXTILE COMPONENT

If you need spare parts, please use the original products. We can provide you with high-quality parts.

SERVICE AND MAINTENANCE

- Get your power tool serviced regularly by a qualified repair person using only identical replacement parts. This will help maintain the safety and performance of your power tool.
- Follow instructions for lubricating and changing accessories.
- Keep handles dry, clean, and free from oil and grease.

CAUTION

FOR YOUR SAFETY

Always ensure the tool is switched off, unplugged, and the battery cartridge is removed before attempting to perform an inspection or maintenance.

MAINTAIN AIRFLOW

Regularly clean the tool's air vents to prevent overheating and ensure optimal performance. Clean them more frequently if working in dusty environments.

CLEANING

Never use gasoline, benzene, thinner, alcohol, or the like. Discoloration, deformation, or cracks may result.

PROFESSIONAL MAINTENANCE

For optimal safety and reliability, we recommend that repairs, and any other maintenance tasks beyond the user capabilities be performed by an Authorized VOGLER Service Center using genuine VOGLER replacement parts.

ENVIRONMENTAL PROTECTION

This electronic device contains components that require special disposal.

To protect resources and the environment, please do not throw it away with regular household garbage.

Recycle this product through your local electronics recycling program.

If you have any questions, you can also contact your local waste management office or a certified electronics recycler.



Vogler Tools

Blindeisenweg 37

41468 Neuss

Tel: +49 2131 2048971



www.voglertools.de



[@voglertools](https://www.instagram.com/voglertools)



[Vogler Tools](https://www.facebook.com/VoglerTools)