

VOGLER[®]

TOOLS, WORK, INTEGRITY

V10345

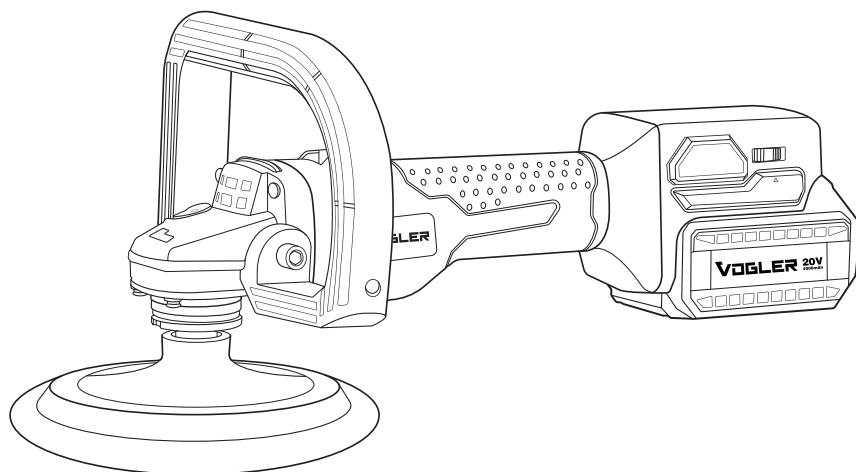

CORDLESS BRUSHLESS POLISHER 20V



TECHNICAL SPECIFICATION

Model	V10345
Motor Type	Brushless Motor
Battery Voltage	20V
Battery Capacity	4.0Ah
Battery Technology	Lithium-ion
No-Load Speed	1300-3500RPM
Spindle Size	M14
Pad Diameter	150mm
Charging Time	60min
Weight (N.W)	2.43Kg
Supplied in	BMC
Includes	Sheep ball (1Pc) Polishing disc(1Pc) Hex wrench(1Pc) Handle(1Pc) Screws (2 Sets)

PART LIST

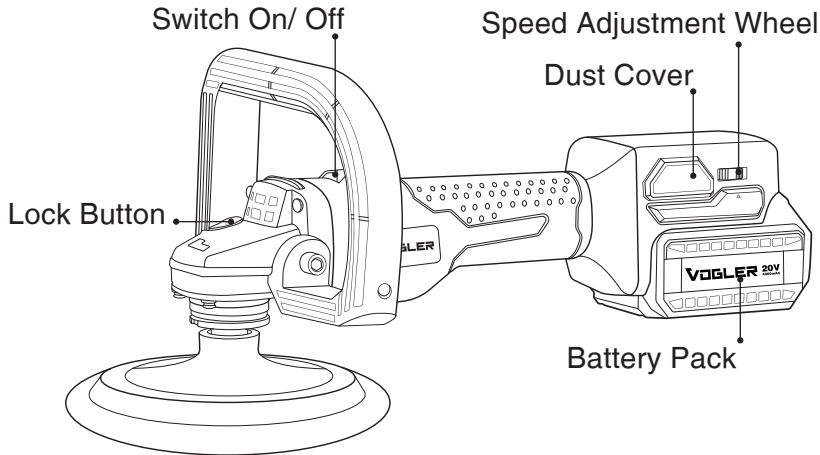

GENERAL SAFETY RULES

⚠ WARNING

Please read all the safety warnings, instructions, and regulations provided with this cordless tool carefully before using it. Failure to follow the instructions listed below, may cause fire or result in electric shock and/or serious injury.

WORKPLACE SAFETY

- Keep the workplace clean and well-lit. Working in disorganized and dark places can cause accidents.
- Do not operate cordless tools in explosive atmospheres, such as near flammable liquid, gas, or dust as the sparks they generate can ignite dust or gas.
- Keep the cordless tools away from children and bystanders during the operation. Being distracted, you might end up losing control of the tool.

ELECTRICAL SAFETY

- Avoid human contact with grounding surfaces, such as pipes, cooling fins, and refrigerators. If you touch the ground surface, you will increase the risk of electric shock.
- Do not expose cordless tools to rain or damp environments. Water entering cordless tools will increase the risk of electric shocks.
- If it is impossible to avoid operating your cordless tools in a humid environment, use a residual current device (RCD) for protection. Using an RCD can reduce the risk of electric shock.
- Cordless tools will produce electromagnetic fields (EMF) that are harmless to users. However, those living with a pacemaker and other similar medical devices should consult the manufacturer and/or a doctor before using these tools.

TIPS ON BATTERY OPERATED TOOLS USE AND MAINTENANCE

- Only use the charger specified by the manufacturer for charging. The charger used for one battery pack may cause fire hazards if used for other packs.
- Only use battery packs specially designed for your tool. Using other battery packs may cause injury and fire hazards.
- When the battery pack is not in use, keep it away from other metal objects, such as paper clips, coins, keys, nails, screws, or other small metal objects, to prevent the negative and positive terminals connect and causing a short circuit which may start a fire or cause an explosion.
- If misused, the battery pack may start leaking. Avoid contact with the liquid and if you did by accident, rinse the contaminated skin thoroughly with water. In case of any contact with the eyes, you should also seek medical help immediately. The fluid spilled from the battery may cause irritation or burns.
- Do not use damaged or modified battery packs as they may cause fire, explosion, or injury.
- Do not expose the battery packs to fire or temperatures higher than 130°C as it may explode.

- Follow the charging instructions. Do not charge the battery pack outside the temperature range specified in the manual. Improper charging or charging outside the specified temperature range, may damage the battery and increase the risk of ignition.

PERSONAL SAFETY

- Stay alert and focused when working with cordless tools. Do not operate these tools when feeling tired or under the influence of drugs, alcohol, or medications. A moment of distraction or lack of attention can lead to serious injuries to the operator.
- Using personal protective equipment is a **MUST**. Always wear safety glasses. Using dust masks, anti-slip safety shoes, safety helmets, hearing protection, and other PPEs based on necessity in different conditions, can reduce the risk of personal injury.
- Prevent accidental starting. Make sure the switch is off before connecting the tool's battery pack, picking it up, or carrying it around. Putting your fingers on the switch while carrying the tool or energizing it when the switch is on, can be dangerous.
- Remove all adjustment keys or wrenches before the cordless tool is turned on. Wrenches or keys left on rotating parts of the tool can lead to injury.
- Don't stretch your hands too far. Always pay attention to the foothold and body balance. This way you can control the cordless tools better in case of an accident.
- Dress appropriately. Do not wear loose clothes or accessories. Keep your hair and clothes away from the moving parts. Loose clothes, accessories, or long hair may get caught in the moving parts.
- If a tool is to be used with chip removal and dust collection equipment, ensure that the equipment is well-connected and properly used. The proper use of dust collection devices can reduce the dangers related to dust.
- Don't be overconfident over your frequent use of cordless tools and ignore the safety precautions. Any careless move and mistake may

cause serious injury before you know it!

TIPS ON CORDLESS TOOL USE AND MAINTENANCE

- Choose cordless tools according to the purpose. This will enhance your efficiency and safety.
- If the switch doesn't turn the power supply on or off, the cordless tool should not be used. Cordless tools that cannot be controlled by switches, are dangerous and must be repaired.
- Before making any adjustments, replacing accessories, or storing the cordless tools, you must remove the battery pack (if detachable). This protective safety measure reduces the risk of accidental starting of the cordless tool.
- Store cordless tools out of children's reach and do not allow people unfamiliar with these tools and those who do not understand these instructions to touch them. Cordless tools are dangerous if used by untrained users.
- Maintain cordless tools and their accessories properly. Check whether the moving parts are in place or stuck, and check the parts for damage and other conditions affecting the operation. If damaged, repair the cordless tool before use. Many accidents are caused by poorly maintained tools.
- Keep the cutting tools sharp and clean. A well-maintained tool with a sharp cutting edge is less likely to get stuck and is easier to control.
- Select the cordless tools, their cutting edges, and accessories according to the instructions in this manual and by taking the working conditions and tasks at hand into consideration. The use of cordless tools for tasks they are not made for can lead to dangerous scenarios.
- Keep the handle and surface dry and clean, free of any grease stain. In the event of an accident, a slippery handle prevents a secure grip and makes it hard to control the tool.
- Avoid operating this tool while wearing cloth work gloves, as they may become tangled and caught in the moving parts, potentially causing injury to the user.

REPAIR

- Leave your tool in the hands of professional maintenance personnel and make sure they replace the faulty parts with identical spare parts. This will ensure the safety of the cordless tool.
- Never repair a damaged battery pack. It can only be repaired by the manufacturer or its authorized service provider.
- Please follow the instructions in this manual, when applying lubricating oil and replacing accessories.

POLISHING

Apply the polish to an area slightly smaller than the area which you intend to polish then by using the appropriate polishing pad, work in the polish using side-to-side or circular motions and applying moderate pressure.

Do not use force or allow the polish to dry out on the surface; this may damage the working surface.

Do not expose the surface which you intend to polish to direct sunlight. Use a clean polishing pad to ensure good polishing results.

WARNING

Failure to follow or misusing the safety rules stated in this instruction manual may cause serious personal injury.

FUNCTIONAL DESCRIPTION

ATTENTION!

Always switch off the tool and remove the battery cartridge before adjusting or checking the function.

THE BATTERY PACK REMOVAL OR INSTALLING

⚠ ATTENTION!

- Be sure to turn off the tool before installing or removing the battery pack.

When installing or removing the battery cartridge, hold the tool and battery cartridge securely. Otherwise, the tool or battery pack may slip out of your hands, resulting in personal injury or damage to the tool and battery pack.

- To remove the battery pack, press the button on the front and pull out the battery pack.

- To install the battery pack, pay attention to aligning the tab on the battery pack with the groove in the case and slide it into place.

- Battery pack should install without additional force, all the way so that it clicks into place with a slight click.

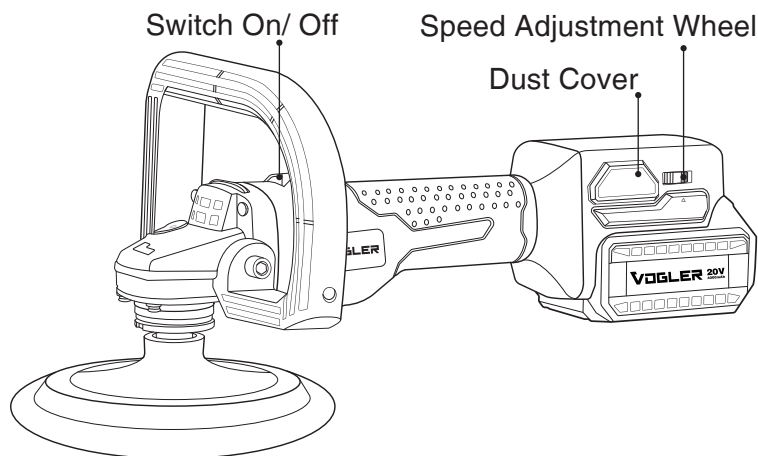

SWITCH ACTION

Before installing the battery cartridge into the tool, always check to see that the switch trigger is actuated properly and returns to the (OFF) position when released.

SPEED ADJUSTING DIAL

The tool speed can be changed by turning the speed adjusting dial to a given number setting from 1 to 6. Number 6 produces the highest speed and number 1 produces the slowest speed.

CAUTION!

If the tool is operated continuously at low speeds for a long time, the motor may get overloaded, resulting in tool malfunction. To prevent that adjust the speed adjusting dial to number 6 at first then far back to number

Do not force the speed-adjusting dial.

CLEANING DUST COVERS

Regularly clean the dust covers on the inhalation vents for smooth air circulation. Remove the dust covers and clean the mesh.

SERVICE AND MAINTENANCE

- Get your power tool serviced regularly by a qualified repair person using only identical replacement parts. This will help maintain the safety and performance of your power tool.
- Follow instruction for lubricating and changing accessories.
- Keep handles dry, clean and free from oil and grease.

CAUTION

For your safety

Always ensure the tool is switched off, unplugged, and the battery cartridge is removed before attempting to perform inspection or maintenance.

Maintain airflow

Regularly clean the tool's air vents to prevent overheating and ensure optimal performance. Clean them more frequently if working in dusty environments.

Cleaning

Never use gasoline, benzene, thinner, alcohol, or the like. Discoloration, deformation, or cracks may result.

Professional maintenance

For optimal safety and reliability, we recommend that repairs, and any other maintenance tasks beyond user capabilities be performed by an Authorized VOGLER Service Center using genuine VOGLER replacement parts.

Environmental Protection

This electronic device contains components that require special disposal. To protect resources and the environment, please do not throw it away with regular household garbage. Recycle this product through your local electronics recycling program.

If you have any questions, you can also contact your local waste management office or a certified electronics recycler.



Vogler Tools

Blindeisenweg 37

41468 Neuss

Tel: +49 2131 2048971



www.voglertools.de



[@voglertools](https://www.instagram.com/voglertools)



[Vogler Tools](https://www.facebook.com/VoglerTools)